



# balto®

ORTHOPAEDIC BRACES FOR ANIMALS



[www.alpha-mobility.com](http://www.alpha-mobility.com)



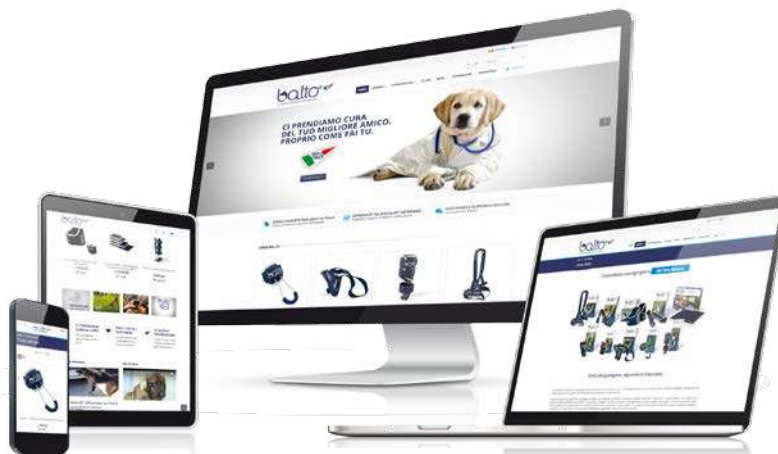

Find out what's new in the world of Balto at:  
**[www.tutoribalto.com](http://www.tutoribalto.com)**



#### **Download the catalog:**

to always have the information you need at your fingertips to choose the best brace for your dog's needs.



#### **Subscribe to our newsletter:**

you will receive valuable information, special interest news and descriptions of Balto products.

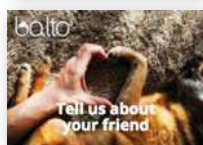

#### **Tell us about your friend:**

along with a few anecdotes about life with your faithful companion and send us some photos of your pet wearing the Balto brace. We will publish the most captivating stories!



#### **Instruction video:**

Are you having trouble putting the brace on your dog? On each product page you will find a video in 2 languages that will walk you through the process and provide valuable information for your dog's wellbeing.

We take care every day of

**their comfort.**

**their future.**

**their health.**

## BALTO: THE DIRECT LINE TO RECOVERY.

The fastest way to health is here, in a range of latest-generation aids, the outcome of **Joyvet**'s long experience, designed to help our friends, both cats and dogs, enjoy a rapid, trouble-free convalescence.

These are products created for particular conditions, made with certified materials of the highest quality, breathable and yet impermeable, combining maximum protection and containment with the highest level of comfort. Comfort that allows the cat and dog to make natural, everyday movements, according to their own instincts, and helping them recover without trauma.

And convenience also for those who love them, because **Balto** products are easy to fit, even by those who are not expert.

With the **Balto line**, the revolution in veterinary orthopaedics has begun. And our injured four-legged friends are already on the road to recovery.



 **JOYVET** s.r.l.



## WE TAKE CARE OF YOUR BEST FRIEND. JUST AS YOU DO.

That's the way we are here at **Joyvet**: meticulous, experienced, with a wealth of know-how in orthopaedics, constantly up to date. And, especially, passionate about what we do. Because we like to see our four-legged friends playing, running and jumping, happy and healthy.

This is why, with experts and vets, we constantly develop high-performance **orthopaedic braces**, which we **make here in Italy**, controlling the entire production chain. These are aids that combine ergonomics, customisation and convenience, perfect for assisting in healing, by immobilising the area concerned without inhibiting movement.

Thanks to our experience here at **Joyvet**, we are convinced that our faithful four-legged companions deserve orthopaedic braces that will give them the best care with the greatest freedom.



All workmanship is carried out by hand, in compliance with the highest safety standards, from cutting of the semi-finished products to the tailored stitching on the braces.

Our staff is comprised of specialized personnel, always at the customer's service to achieve the best possible results every day.

Artisan craftsmanship, attention to detail, unique product features, made in Italy - these are the values we believe in.



#### **Metal parts:**

The first phase of workmanship involves the creation of the ribs, small contoured metal strips used in the areas that offer support, locking and stability in the Linea Balto braces.

All the internal ribs on our braces are laser-cut in-house and then undergo a vibro finishing process that rounds and smooths the sharp edges of the laser-cut pieces.

The ribs are then dried using corn-cob granulates, entirely natural abrasive granules also used for sandblasting and abrasive finishing of surfaces.



#### **Coverings:**

At the same time, all of the semi-finished fabric pieces are prepared. First is the punching operation: an operator uses a die-cutting machine to cut the material to size and shape.

#### **Final product:**

Then, specialized staff assemble the final product by hand-stitching and finishing each item.



**BALTO: MADE IN ITALY, MADE BY HAND,  
FROM RAW MATERIALS TO FINISHED PRODUCT.**

## **BALTO OFF-ROAD** ADJUSTABLE ORTHOPEDIC WHEELCHAIR FOR DISABLED DOGS



The Balto Off-Road wheelchair was created to assist dogs with motor disabilities or difficulty walking due to disease or old age.

Hip dysplasia, degenerative myelopathy, severe arthritis of the hind legs, neurological disorders and deterioration of the rear joints that prevents the dog from standing unaided are the diseases for which it is most often indicated.

Made of anodized aluminum, the wheelchair is lightweight, strong and extremely stable. It comes in three sizes that can be adjusted in width, height and length.

Safety straps across the front ensure a superior fit to the dog. During use, an X-shaped harness at the rear comfortably supports the dog. In addition, the harness allows the dog to defecate and urinate without soiling the wheelchair (e.g.: cases of incontinence).

Balto Off-Road also comes with dual velour loops for the hind legs, designed to limit stress and relax the dog during walks. The wheelchair is engineered to allow the dog to move on any type of terrain; the rubber wheels ensure excellent stability. It comes complete with an upper handle that can be attached, if needed; this allows the owner to lift the dog in cases of severe motor difficulty or to help the dog move over an obstacle, such as going up or down steps or getting on and off a curb. All the safety straps are covered in soft, breathable Balto material and are hand-washable.

### FEATURES

- ▶ Lightweight.
- ▶ Adjustable in all directions.
- ▶ Durable.
- ▶ Safety straps are soft, breathable and hand-washable.



Fascia accorciabile

### RECOMMENDATIONS FOR USE

- ▶ All the screws have self-locking nuts; once the owner has adjusted the wheelchair, the screws must be tightened all the way.

**NB: the adjustable connector rod between the wheels must always be screwed into the lowest position on the wheelchair, especially if it is used by very heavy dogs (more than 35 kg).**

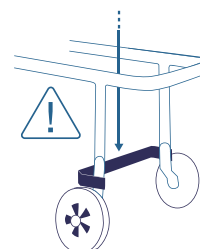

**NB: The adjustable rod can be rotated 180 degrees to allow the dog to use the hind legs to walk, for example during rehabilitation.**

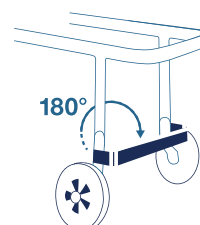



**balto**  
TUTORI ORTOPEDICI PER ANIMALI

## HOW TO MEASURE FOR SIZE

After carefully calculating A, B and C and weighing the dog, refer to the chart.

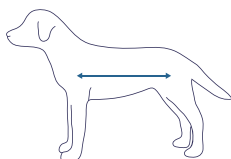

**A Length:**  
- Center of shoulder  
- Center of thigh

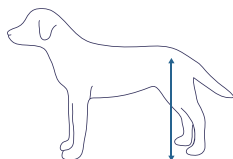

**B Height**  
- measure from  
hip to ground

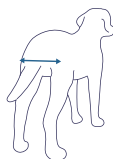

**C Width:**  
- measure horizontally  
leg-to-leg above the tail

## MEASUREMENTS in centimeters (cm)

| Size     | A     | B     | C     | Weight   |
|----------|-------|-------|-------|----------|
| <b>S</b> | 22-32 | 15-30 | 10-20 | 5-14 kg  |
| <b>M</b> | 33-54 | 31-50 | 21-26 | 15-26 kg |
| <b>L</b> | 55-85 | 50+   | 27-35 | 27-50 kg |

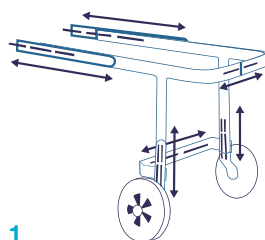

**1**

Adjusting the rods. First, slide the aluminum rods until the measured dimensions are reached. To adjust the wheelchair's rods in height, length and width, you must remove the screws and the self-locking nuts using a Phillips-head screwdriver and pliers.

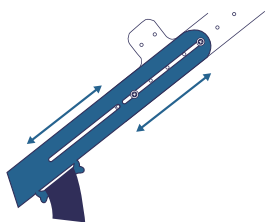

**2**

Once adjusted, you need to fully tighten all the screws and self-locking nuts to ensure that the movements caused by use do not cause the screws to loosen over time, resulting in a loss of rigidity and stability.

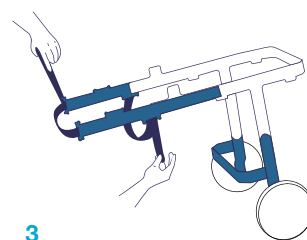

**3**

Adjust the front body straps. The length of every strap can be adjusted to fit your dog's size.

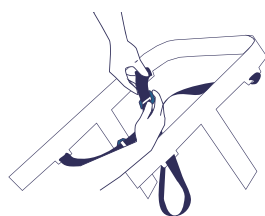

**4**

To adjust the 'X-shaped' harness, where the dog's hind legs are inserted, you need to remove the velcro padding and loosen or tighten the straps using the plastic double ring closure.

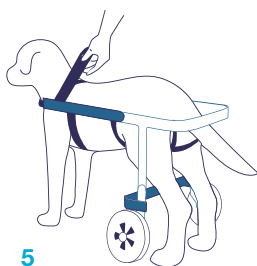

**5**

Place the dog inside the wheelchair, closing the upper strap and then adjusting the straps around the front of the chest and under the rib cage (behind the front legs).

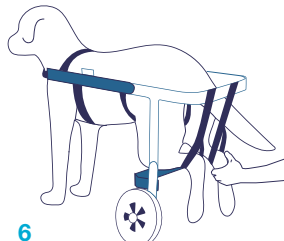

**6**

When the wheelchair is in use, it is possible to place the dog's hind legs through the two velour loops to limit stress on the joints caused by movement.

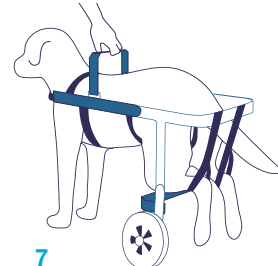

**7**

Balto Off-Road comes with a handle for carrying or lifting your dog, useful in cases that are more severe due to near or total loss of mobility.



## BT LUX SHOULDER BRACE



The BT Lux brace is designed to limit overall abduction of the shoulders of your 4-legged friend. It can be used for minor issues (like inflammation) and for shoulder diseases that require limiting abduction and movement of the joint. It can also be used as a post-operative device to promote gradual rehabilitation of the joint.

It is helpful for:

- instability of the shoulder joint;
- dysplasia;
- joint laxity or hypermobility;
- dislocation;
- inflammation.

Support is provided by stiff material inside the brace at shoulder height to increase compression and limit movement of the joints.

### ADVANTAGES

BT Lux works with your dog to gradually regain motor function. The comfortable padding combines practicality, convenience and optimal stabilization.

### FEATURES

- ▶ The brace simultaneously compresses both shoulders.
- ▶ Breathable fabric.
- ▶ Adjusts for a better fit.
- ▶ Can be hand-washed.



### RECOMMENDATIONS FOR USE

- ▶ During the period of restraint, it is recommended that the dog not be left alone very long because it could try to remove the brace by biting or scratching it.
- ▶ The length of all of the straps and closures can be adjusted for a better, tighter fit to the dog (see figure 3).

### SIZES

Available in three adjustable sizes.



10-19 kg



20-49 kg



50-80 kg

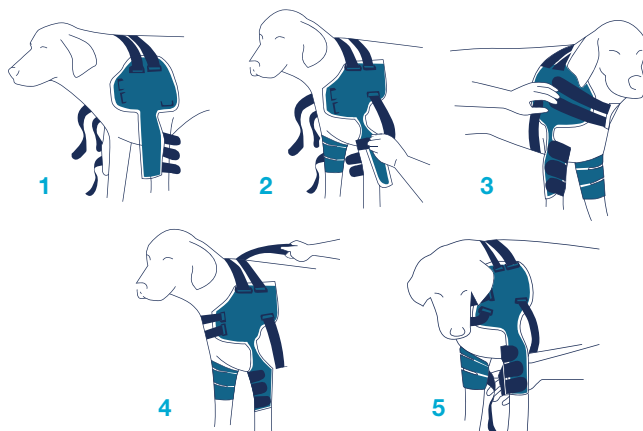

There are two straps between the elbow joint braces that can be used to bind the two joints together. **Note:** this solution is only required when used post-operatively or in case of serious disease that requires greater limitation of movement of the anterior joints. If there is no need to bind the two elbow braces, the safety straps can simply be neatly closed upon themselves.



balto  
TUTORI ORTOPEDICI PER ANIMALI



## BT BONE BRACE FOR FRACTURES OF THE FRONT LEG (RADIUS-ULNA AND RADIUS-CARPUS)



The BT Bone brace is an alternative to the more common splints or casts used to treat traumas caused by fractures to the front leg including those between the radius-ulna and radius-carpus.

It comes with three rigid splints - one fixed splint contained in a pocket on the center back and two side splints with Velcro backing which allows them to be positioned as needed for optimum effectiveness.

The splints ensure both support and stabilization of the fractured limb throughout the healing period prescribed by your vet.

The brace is designed for daily use, thanks to the breathable fabric that prevents blisters and sores caused by sweating.

When using the BT Bone brace, we recommend combining it with the BT Joint, because its use on the healthy joint will help the dog compensate better for the added load caused by the loss of use of the fractured leg.

Once the brace has been placed around the dog's leg, it is not necessary that the two white-trimmed edges meet, since the closure of the brace is by means of the blue straps and stabilization is provided by the three splints contained in the brace.

### FEATURES

- ▶ Breathable fabric.
- ▶ Adjustable fit.
- ▶ Can be hand-washed.

### RECOMMENDATIONS FOR USE

- ▶ During the period of restraint, it is recommended that the dog not be left alone very long because it could try to remove the brace by biting or scratching it.
- ▶ Remove the splints before every laundering.

### SIZES

Available in six sizes, all adjustable in width thanks to the breathable velvet straps that allow the brace to be enlarged or tightened.



**Note:** the weights indicated are purely indicative. If in doubt, rely exclusively on the size measurements in cm indicated below.

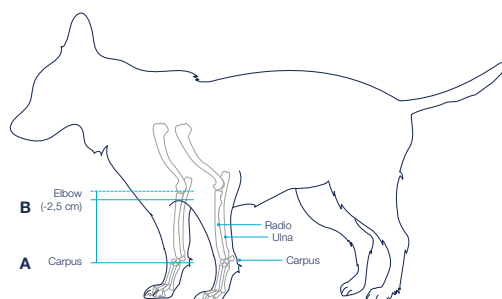

With an accurate measuring tape, measure the length of the front leg (from the carpus to 2.5 cm below the elbow) and compare it with the size chart on the right.



### Tg. Length from A to B

|            |            |
|------------|------------|
| <b>XS</b>  | 8-10,5 cm  |
| <b>S</b>   | 11-14 cm   |
| <b>M</b>   | 14,5-18 cm |
| <b>L</b>   | 18,5-21 cm |
| <b>XL</b>  | 22-27 cm   |
| <b>XXL</b> | over 27 cm |

## **BT BODY LIFT**

- 1) ONE-PIECE BACK BRACE WITH HANDLE, FOR DOGS WITH AGE- OR DISEASE-RELATED MOTOR DIFFICULTIES
- 2) SUPPORTS THE SPINAL COLUMN



The BT BODY LIFT serves 2 specific functions:

- 1) It is indicated for dogs that have difficulty walking, as a result of trauma, disease or paralysis, as well as for dogs with motor difficulties;
- 2) It is also indicated for dogs with spinal column issues. The two (removable) rigid splints, contained in the two side pockets, serve to both stabilize the brace during use, as well as to compress the proximal area of the spinal column in cases of disease in this area, holding it in traction (for example, neurological diseases).

### **ADVANTAGES**

BT Body Lift is made of soft, washable, breathable material. The height-adjustable handle straps are durable and make it possible to lift even large dogs. The padded handle grip allows the owner to support the dog without undue stress on the hand.

The brace is engineered to allow the dog to eliminate naturally while wearing it without soiling the brace because the dog's orifices are not covered by the brace.

Both the handle straps and the splints can be removed.

### **FEATURES**

- ▶ Breathable fabric.
- ▶ Adjusts for a better fit.
- ▶ Can be hand-washed.
- ▶ The handle straps can be adjusted for height.
- ▶ Body straps can be shortened.
- ▶ Rigid lateral splints offer greater stability.

### **RECOMMENDATIONS FOR USE**

- ▶ During the period of restraint, it is recommended that the dog not be left alone too long because it could try to remove the brace by biting or scratching it.
- ▶ Be careful when putting the brace on male dogs. While wrapping the body strap around the pelvis, ensure the strap passes well in front of the penis to avoid compression of the urethra.



## SIZES

**Tg.** Length from A to B

|           |            |
|-----------|------------|
| <b>XS</b> | 25-32 cm   |
| <b>S</b>  | 33-39 cm   |
| <b>M</b>  | 40-49 cm   |
| <b>L</b>  | 50-59 cm   |
| <b>XL</b> | over 60 cm |



Shortenable bandages

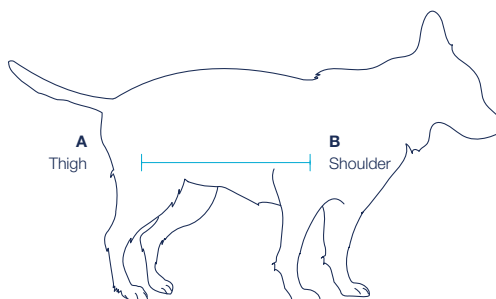

How to measure for size: measure the distance in cm from the center of the shoulder to the center of the thigh and check it against the table.

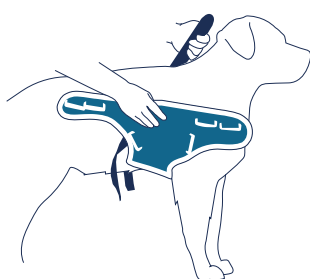

1

Position the brace near the dog's front legs. The front of the brace should touch the armpits of the dog's front legs.

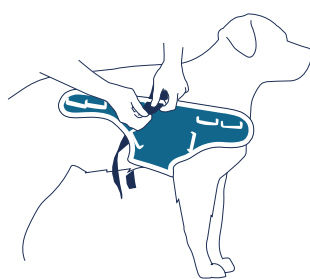

2

Pull the brace up, around the dog's trunk and fasten it by pulling the velcro straps through the white guide rings. The number of guide rings varies depending on size. Now, close the front part with a horizontal strap that is pulled through the dedicated white guide ring.

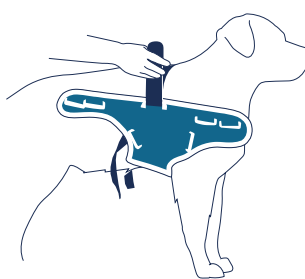

3



4

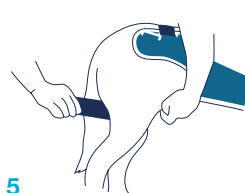

5

Starting from the inside, draw the straps around each leg. Pull the strap through the diagonal white guide ring and use the velcro end to lock it into place. Be careful not to over-tighten.

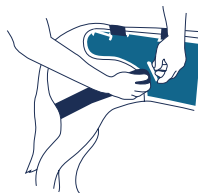

6

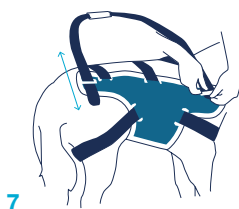

7

The length of the handle straps can be adjusted to suit your height. Just loosen the Velcro straps and adjust to make them longer or shorter, allowing you to walk in a natural position alongside the dog.

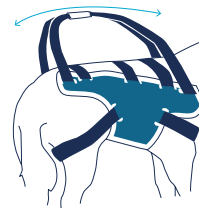

8

Once the brace is in place, it's time to attach the handle straps. To position the handle grip, locate the dog's center of gravity so that when you lift the dog, it stays level and doesn't tilt forward or back.

## BT JUMP KNEE BRACE



Designed for cases of cruciate ligament, luxation of the patella, knee joint conditions such as arthritis and arthrosis, varus and valgus. It can be used both as an alternative to surgery, and in post-surgery. The brace has two pockets, which contain two angled splints that restrict the movement of the knee when necessary. An abdominal band ensures the brace is well secured around the dog. The brace can also be used without splints for conditions such as arthritis and arthrosis. This is because the compression it provides increases the blood pressure in the area, thus raising the temperature and reducing the pain caused by the conditions.

### ADVANTAGES

Ensuring the stability of the affected part often means aiding recovery. Two angled lateral splints in aluminium inserted into special pockets restrict movement, as required, controlling the area that needs to be held still, while the abdominal belt keeps the support in place, making sure it does not slip down or rotate.

### FEATURES

- ▶ The brace can be used in pre- and post-surgery.
- ▶ Breathable fabric.
- ▶ Excellent wearability.
- ▶ Hand washable.
- ▶ Shortenable bandages.



### RECOMMENDATIONS FOR USE

- ▶ During the period of restraint, it is advisable not to leave the dog alone for too long, because it might try to remove the brace by biting or scratching it.
- ▶ Be careful of the band when applying the brace to a male dog. When wrapping the band around the pelvis, pass the band in front of foreskin in order to avoid compressing the urethra.

### SIZES

| Tg.  | Circ. A    | Circ. B  | h A-B |
|------|------------|----------|-------|
| XXS* | 13-8 cm    | 5-3 cm   | 8 cm  |
| XS   | 18-16 cm   | 7-5 cm   | 10 cm |
| S    | 25-21 cm   | 15-8 cm  | 15 cm |
| M    | 31-26 cm   | 16-10 cm | 18 cm |
| L    | 34-29 cm   | 18-12 cm | 22 cm |
| XL   | over 36 cm | -        | 25 cm |

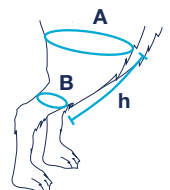

**balto**  
ORTHOPEDIC BRACES FOR ANIMALS

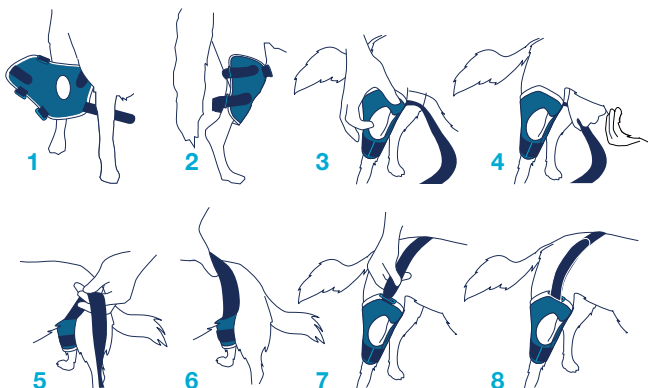

## BT JUMP PLUS DUAL KNEE BRACE



Designed for cases of cruciate ligament, luxation of the patella, knee joint conditions such as arthritis and arthrosis, varus and valgus. It can be used both as an alternative to surgery, and in post-surgery. The brace has two pockets, which contain two angled splints that restrict the movement of the knee when necessary. The brace can also be used without splints for conditions such as arthritis and arthrosis. This is because the compression it provides increases the blood pressure in the area, thus raising the temperature and reducing the pain caused by the conditions.

### ADVANTAGES

Ensuring the stability of the affected part often means aiding recovery. Two angled lateral splints in aluminium inserted into special pockets restrict movement, as required, controlling the area that needs to be held still, while the abdominal belt keeps the support in place, making sure it does not slip down or rotate.

### FEATURES

- ▶ The brace can be used in pre- and post-surgery.
- ▶ Breathable fabric.
- ▶ Excellent wearability.
- ▶ Hand washable.
- ▶ Shortenable bandages.



### RECOMMENDATIONS FOR USE

- ▶ During the period of restraint, it is advisable not to leave the dog alone for too long, because it might try to remove the brace by biting or scratching it.

### SIZES

| Tg.  | Circ. A    | Circ. B  | h A-B |
|------|------------|----------|-------|
| XXS* | 13-8 cm    | 5-3 cm   | 8 cm  |
| XS   | 18-16 cm   | 7-5 cm   | 10 cm |
| S    | 25-21 cm   | 15-8 cm  | 15 cm |
| M    | 31-26 cm   | 16-10 cm | 18 cm |
| L    | 34-29 cm   | 18-12 cm | 22 cm |
| XL   | over 36 cm | -        | 25 cm |

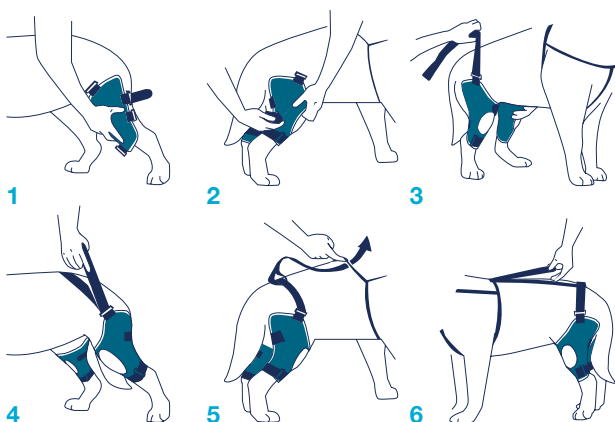
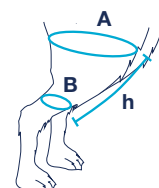

\* XXS size is recommended for Chihuahua and dogs weighing 2-4 kg.

## BT NECK RIGID ORTHOPAEDIC NECK BRACE



BT Neck is an orthopaedic brace designed to help cats and dogs with problems with their cervical vertebrae, crushed vertebrae, neurological issues and hernias.

The compression offered by the brace ensures compression and traction of the neck, thus protecting it in case of injuries. It is also helpful in cases of obsessive-compulsive behaviors. Its secondary purpose is that of a valid alternative to the Elizabethan collar (cone of shame), which keeps the dog from biting the part of the body affected by surgery. In this way, the dog cannot remove the stitches or ingest medicines applied to the wound, protecting the areas of the chest, the abdomen and the flanks and making it difficult to reach the areas around the front paws (elbow to shoulder). It also protects the perianal area which may have been involved in surgeries to remove anal glands, fistulas, etc.

### ADVANTAGES

Easier to put on and less restrictive than the Elizabethan collar (the dog can still eat and drink without restriction).

### FEATURES

- ▶ Waterproof breathable fabric (in case of rain).
- ▶ The brace can be worn before and after surgery.
- ▶ Excellent wearability.
- ▶ Hand washable.

### RECOMMENDATIONS FOR USE

- ▶ The BT Neck collar is not suited for hounds and bulldogs. The long necks of the former do not allow the collar to stay in place, while the short, thick neck of the bulldog does not allow for proper fit.
- ▶ For proper use, it is essential that the collar be tightened securely around the neck, to keep it from turning.
- ▶ While wearing the rigid collar, the dog can be taken for walks using either the collar or a harness.
- ▶ Over a 24-hour period, remove the collar for 1 to 2 hours.

### SIZES

Available in six adjustable sizes. To determine the proper size, measure the circumference of the dog's neck with a tape measure (measure at the midpoint of the neck).

#### Size Neck circumference

|     |  |
|-----|--|
| XXS | one size only for all cats and for dogs like Chihuahuas or of similar size |
| XS  | 25-35 cm   |
| S   | 35-45 cm   |
| M   | 45-55 cm   |
| L   | 55-65 cm   |
| XL  | 65-75 cm   |



## BT NECK ECO NO-LICK NECK BRACE



The BT Neck Eco was designed as an alternative to the classic Elizabethan collar (cone of shame), and neatly outperforms it by combining efficacy and the utmost in comfort.

Its purpose is to prevent the dog or cat from biting and thus being able to remove stitches after surgery.

It is also helpful in cases of obsessive-compulsive behaviors. The collar is made of black, breathable velour, and the inside is made of a more rigid fabric that keeps the pet from turning its neck far enough to reach any wounds.

For dogs, it prevents licking areas on the chest, abdomen and flanks making it difficult to reach the areas close to the front paws (elbow to shoulder). It also protects the perianal area, which may have been involved in surgeries to remove glands, fistulas, etc.

For cats, it should only be used after sterilization surgery on both males and females.

### ADVANTAGES

Easier to put on and wear and is less restrictive than the plastic cone (the dog can still eat and drink without difficulty).

### FEATURES

- ▶ Breathable, but not waterproof, fabric.
- ▶ The brace can be worn before and after surgery.
- ▶ Excellent wearability.
- ▶ Hand washable.

### RECOMMENDATIONS FOR USE

- ▶ The BT Neck Eco collar is not suited for hounds and bulldogs. The long necks of the former do not allow the collar to stay in place, while the short, thick neck of the bulldog does not allow for proper fit.
- ▶ For proper use, it is essential that the collar be tightened securely around the neck, to keep it from turning.
- ▶ During convalescence with BT Neck Eco, the dog can be taken for walks using either the collar itself or a harness.
- ▶ Over a 24-hour period, remove the collar for 1 to 2 hours.
- ▶ The collar is not recommended for use in the case of surgery to the front paws (from the elbow to the foot).

### SIZES

Available in six adjustable sizes. To determine the proper size, measure the circumference of the dog's neck with a measuring tape (measure at the midpoint of the neck).

#### Size Neck circumference

|     |  |
|-----|--|
| XXS | one size only for all cats and for dogs like Chihuahuas or of similar size |
| XS  | 25-35 cm   |
| S   | 35-45 cm   |
| M   | 45-55 cm   |
| L   | 55-65 cm   |
| XL  | 65-75 cm   |

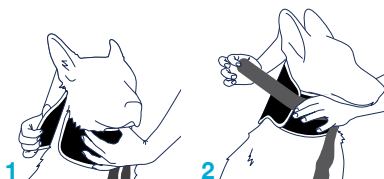

**NB: This collar is designed purely to prevent licking.** If the animal is suffering from cervical spine issues, crushed vertebrae or neurological problems, it is better to order the rigid orthopaedic BT Neck.

## BT JOINT CARPAL BRACE



The carpal brace is used for conditions involving lesions to the carpus, leading to pain, lameness, or difficulty in moving. It provides great protection for bandages and plasters when treating surgical wounds (arthrodesis) or licking sores. It also gives great results in pre-operative care: acute or chronic arthritis (osteoarthritis, osteochondrosis and similar conditions) and injuries to the ligaments are no longer a problem.

The brace can also be used without splints for conditions such as arthritis and arthrosis. This is because the compression it provides increases the blood pressure in the area, thus raising the temperature and reducing the pain caused by the conditions.

Once the brace has been placed around the dog's leg, it is not necessary that the two white-trimmed edges meet, since the closure of the brace is by means of the blue straps and stabilization is provided by the splints on the back of the brace.

### ADVANTAGES

Choosing the excellence of the BT Joint carpal brace means ensuring maximum stability of the injured area, with a consequent reduction in swelling. BT Joint promotes improved balance between the muscle groups in the carpal area, thus facilitating motor functions and also promoting healing.

### FEATURES

- ▶ The brace can be used in pre- and in post-surgery.
- ▶ Breathable fabric.
- ▶ Excellent wearability.
- ▶ Hand washable.

### RECOMMENDATIONS FOR USE

- ▶ During the period of restraint, it is advisable not to leave the dog alone for too long, because it might try to remove the brace, by biting or scratching it.
- ▶ Always remove the rigid splints before washing.

### SIZES

Available in five adjustable sizes.

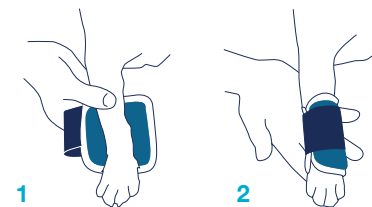



## BT SPLINT INSTABILITY BRACE



The brace is specially designed to support the radiocarpal, carpometacarpal and tarsometatarsal joints, both the front and back paws. It is ideal for cases of hyperflexion or hyperextension of the carpus and tarsus, minor ligament distortions, sprains and incomplete fracture of the bone, when conservative treatment is preferable to surgery.

When used on the front leg, we recommend also using the BT Joint, because its use on the healthy leg will help the dog compensate better for the added load caused by the loss of use of the other leg. If the BT Splint is used on a hind leg, we recommend using the BT Joint on both front legs.

Once the brace has been placed around the dog's leg, it is not necessary that the two white-trimmed edges meet, since the closure of the brace is by means of the blue straps and stabilization is provided by the splint on the back of the brace.

### ADVANTAGES

Effective, practical, ergonomic: the BT instability Splint is all of this. The robust, mouldable metal splint contained within the fabric follows the shape of the rear part of the antebrachium right down until it encloses the footpad, stabilising the affected area and allowing the dog a good degree of movement. Also ideal for protecting bandages inserted inside, it makes for faster recovery times.

### FEATURES

- ▶ The XXS and XS sizes can also be used on cats.
- ▶ Tough, mouldable metal splint.
- ▶ Breathable fabric.
- ▶ Wearability.
- ▶ Hand washable.
- ▶ The brace can be used in pre- and post- surgery.

### RECOMMENDATIONS FOR USE

- ▶ During the period of restraint, it is advisable not to leave the dog alone for too long, because it might try to remove the brace by biting or scratching it.



- ▶ The brace is designed for indoor use. To prevent damage when used outside, the dog needs to be fitted with a protective shoe or sock, which can be purchased at any pet store.

### SIZES

The sizes are purely indicative - those indicated may not be applicable to some breeds.

If for use on the back paw, order one size down from that shown for the weight (for example: if the dog weighs 27 kg, for the front paw choose size M, for the back paw choose size S).



The splint is pre-shaped but the angle can be modified by the vet if required. The tough, mouldable metal splint inserted inside the fabric follows the shape of the rear of the foreleg, down to the foot pad. Protective bandaging can be effectively placed inside it.

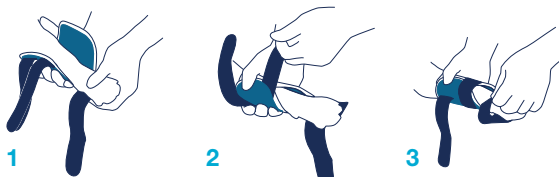

## BT PULL

BRACE FOR NEUROLOGICAL DISORDERS PARALYSIS OF THE LIMBS WITH HYPERFLEXION OF THE PHALANGES AFFECTING THE SCIATIC NERVE, THE COMMON FIBULAR NERVE, BRACHIAL PLEXUS, OR RADIAL NERVE.



The brace can be used for neurological disorders that cause severe proprioceptive deficits, which mean that the dog is unable to sense the position of the limb on the ground, thus tending to stand on the back of its paw (dorsiflexion). BT Pull is also used in cases of damage to the sciatic nerve (for example as a result of a fracture of the pelvis or femur), in order to ensure that the neurological problem does not lead to orthopaedic damage due to shortening of the flexor tendons of the foot. The brace can be used to: prevent incorrect application of weight on the limb; ensure correct, continuous stimulation of the proprioceptive nerves, also when walking; provide constant stretching of the toes and thus of the flexor tendons of the toes, thereby ensuring that they do not shorten.

### FEATURES

- ▶ Breathable fabric.
- ▶ Hand washable.
- ▶ Excellent wearability.
- ▶ The package contains a reinforcement made of thick material for use in cases of severe hyperflexion of the phalanges, ensuring that they open more completely, also in the case of big dogs. The reinforcement can be removed if not needed.

### RECOMMENDATIONS FOR USE

- ▶ During the period of restraint, it is advisable not to leave the dog alone for too long, because it might try to remove the brace by biting or scratching it.
- ▶ The knot at the top of the brace can be untied so that the elastic fascia can be adjusted to increase or decrease its tension, thus adjusting the opening of the dog's phalanges.

### SIZES

Available in four sizes.



5-10 kg



10-20 kg



20-40 kg



over 40 kg

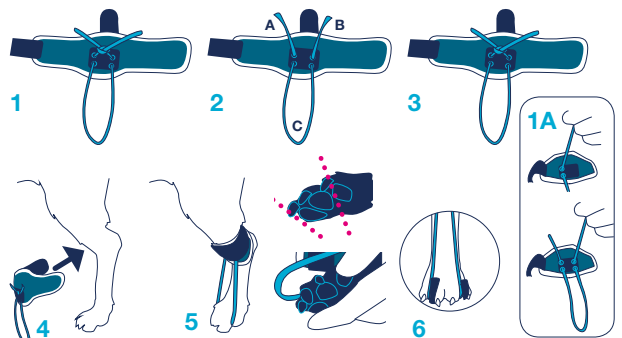

balto  
ORTHOPAEDIC BRACES FOR ANIMALS



Pain, lameness and neuromuscular difficulties are no longer an issue: BT Hock is used in conditions that cause lesions in the region of the hock joint. The brace has three pockets in order to insert two rigid lateral splints and an adjustable fore splint.

It is used for symptoms such as pain, lameness or difficulty in moving.

The brace can also be used without splints for conditions such as arthritis and arthrosis. This is because the compression it provides increases the blood pressure in the area of the hock, thus raising the temperature. This reduces the pain caused by the conditions.

The fore splint is recommended for those cases in which it is necessary to completely block the hock joint (for example after surgery or because of neurological problems).

Used also for protection purposes, it can contain plasters or bandages, with or without medication, in the case of surgical wounds or pressure sores. Also excellent after surgery.

### FEATURES

- ▶ Breathable fabric.
- ▶ Excellent wearability.
- ▶ The brace can be used in pre- and in post-surgery.
- ▶ Two rigid lateral splints and the adjustable fore splint are included with the brace.
- ▶ The splints can be removed by extracting them from their pockets.
- ▶ The fore splint is adjustable.

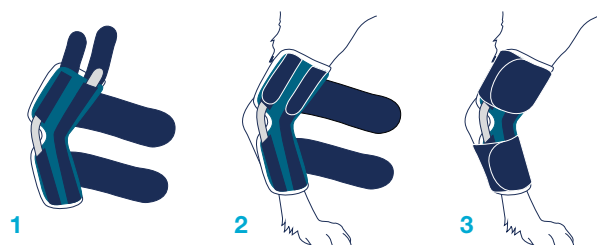

### RECOMMENDATIONS FOR USE

- ▶ During the period of restraint, it is advisable not to leave the dog alone for too long, because it might try to remove the brace by biting or scratching it.
- ▶ **Caution:** direct contact between the splints and the skin means that the brace may cause reddening if the dog is taken out to play or run while wearing it. We recommend that this be prevented by placing some gauze or cotton wool between the splints and the skin.
- ▶ Consult a veterinarian when using rigid splints.
- ▶ Always remove the rigid splints before washing.

### SIZES

Available in five adjustable sizes:



\* XXS size is recommended for Chihuahua and dogs weighing 2-5 kg.

## BT SOFT ELBOW BRACE



BT Soft is the perfect companion for looking after the dog's elbow, protecting it in the case of hygromas, sores and elbow calluses. The brace is also ideal for use in the presence of conditions such as arthritis, arthrosis or elbow displasia. This is because the compression it provides increases the blood pressure in the area, thus raising the temperature and reducing the pain caused by the conditions. It keeps the injured area compressed and is extremely efficient also to protect medications applied to the skin after surgery.

### ADVANTAGES

With its replaceable padding, the BT Soft brace combines top performance with maximum comfort. Used after surgery, it facilitates recovery in trouble-free convalescence.

### FEATURES

- ▶ The brace can be used in pre- and in post-surgery.
- ▶ Breathable fabric.
- ▶ Excellent wearability.
- ▶ The box contains two spare pads.
- ▶ Hand washable.
- ▶ Shortenable bandages.



### RECOMMENDATIONS FOR USE

- ▶ During the period of restraint, it is advisable not to leave the dog alone for too long, because it might try to remove the brace, by biting or scratching it.

### SIZES

Available in four adjustable sizes, for left and right.

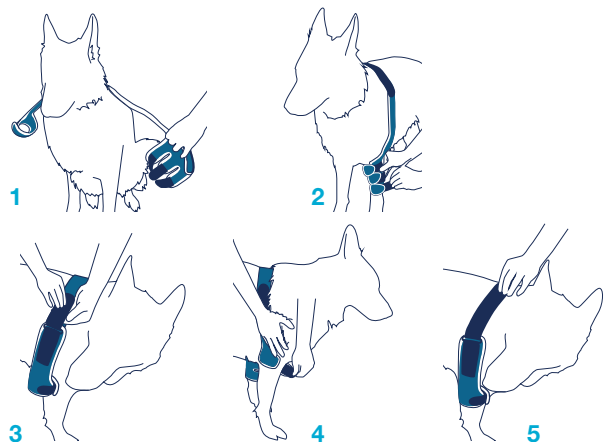

**balto**  
ORTHOPAEDIC BRACES FOR ANIMALS

## BT SOFT PLUS DOUBLE ELBOW BRACE



With BT Soft Plus, protecting an elbow affected by hygromas, sores and calluses is dead simple. The brace is also ideal for use in the presence of conditions such as arthritis, arthrosis or elbow displasia. This is because the compression it provides increases the blood pressure in the area, thus raising the temperature and reducing the pain caused by the conditions. It is also perfect for containing post-operative dressings in direct contact with the skin, such as in the case of surgical operations on dogs suffering from bilateral sterile inflammation of the olecranon bursa.

### ADVANTAGES

Great freedom of movement as the dog races towards rapid recovery: that is the promise of a brace with such excellent performance as the BT Soft Plus.

The comfortable replaceable padding combines convenience, comfort and excellent stability. BT Soft Plus is a loyal friend for your dog's health.

### FEATURES

- ▶ The brace can be used in pre- and in post-surgery.
- ▶ Breathable fabric.
- ▶ Excellent wearability.
- ▶ The box contains two spare pads.
- ▶ Hand washable.
- ▶ Shortenable bandages.



### RECOMMENDATIONS FOR USE

- ▶ During the period of restraint, it is advisable not to leave the dog alone for too long, because it might try to remove the brace, by biting or scratching it.

### SIZES

Available in four adjustable sizes.

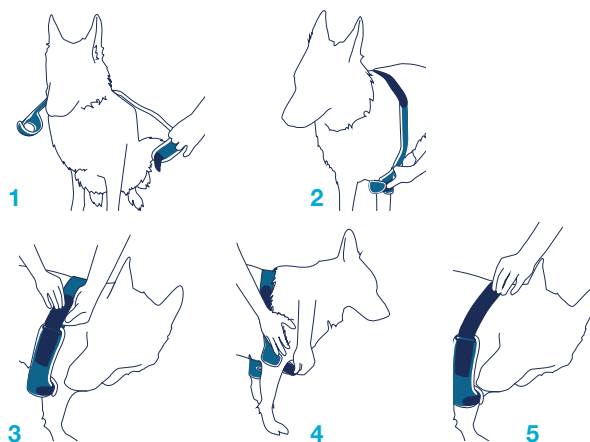

**balto**  
ORTHOPAEDIC BRACES FOR ANIMALS

## BT UP HIND-LEG SUPPORT



**balto**  
ORTHOPAEDIC BRACES FOR ANIMALS

BT Up is the perfect support for dogs suffering from conditions such as arthritis, osteoarthritis, hip dysplasia and paralysis or semi-paralysis of the hind legs. The support is an effective aid to allow the animal to walk more easily, thus continuing to enjoy daily actions with its owner, such as walking or going up the stairs. The effectiveness of BT Up is also recognised by veterinarians who use it in physiotherapy and rehabilitation programmes.

### ADVANTAGES

Extremely practical, with height-adjustable handles; excellent stability thanks to the use of two rigid splints in special pockets on the sides; real comfort, obtained by the use of top-quality, completely breathable materials: this is what makes BT Up so great. And, what is more, the design allows the animal to urinate and defecate without dirtying itself.

### FEATURES

- ▶ The brace can be used in pre- and post-surgery.
- ▶ Breathable.
- ▶ Hand washable.
- ▶ Height-adjustable.
- ▶ Rigid lateral splints for greater stability.
- ▶ Shortenable bandages.



### RECOMMENDATIONS FOR USE

- ▶ To choose the right size, it is important to measure the circumference of the thigh and to follow the indications shown.

### SIZES

|           | <b>Circ.</b> |
|-----------|--------------|
| <b>XS</b> | 15-20 cm     |
| <b>S</b>  | 25-30 cm     |
| <b>M</b>  | 30-35 cm     |
| <b>L</b>  | 40-45 cm     |
| <b>XL</b> | 50-55 cm     |

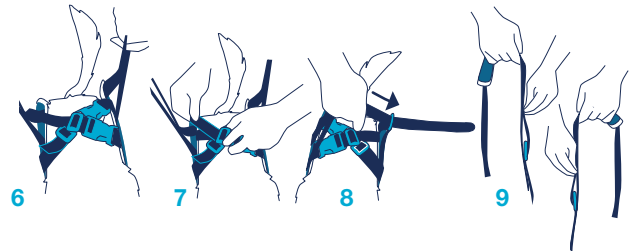
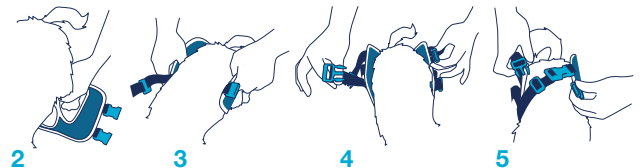
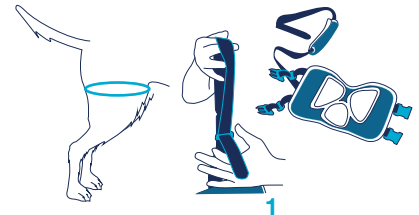

## BT BLUE CARPET

### ORTHOPAEDIC MEMORY FOAM MATTRESS WITH ANTI-DECUBITUS PROPERTIES



The BT Blue Carpet dog bed is crafted entirely of Italian-made materials and was designed for older dogs and dogs suffering from bed sores. The properties of the breathable memory foam material are the same for dogs as they are for humans:

- ▶ ensure proper nighttime rest;
- ▶ support of blood and lymphatic circulation, fostering recovery;
- ▶ support of good animal posture.

Also suited for dogs who suffer from bed sores because it slows their progression, boosting healing time when used in conjunction with your vet's treatment plan.

BT Blue Carpet dog bed can also be used as a post-op recovery bed.

#### FEATURES

- ▶ Cover is completely removable and can be hand-washed.
- ▶ The lining is made of a breathable, waterproof material that makes it easy to clean, even in cases of pet incontinence.

#### SIZES

The BT Blue Carpet comes in four sizes.

#### MEMORY FOAM TECHNOLOGY



60x50x7 cm  
0-15 Kg



80x70x7 cm  
15-25 Kg



100x70x7 cm  
25-45 Kg



120x80x7 cm  
over 45 Kg

# balto®

ORTHOPAEDIC BRACES FOR ANIMALS

by  JOYVET s.r.l.

Via Volta, 27 - 37062 Dossobuono VR - Italy

[www.alpha-mobility.com](http://www.alpha-mobility.com)



These products are intended **for sale only**.  
**Rental is strictly prohibited.**  
Due to normal wear and tear, a brace already worn  
by one animal loses its effectiveness.